



Twin Theatre Operating Suite

Royal Berkshire NHS Foundation Trust

Royal Berkshire Hospital, Reading



For permanent solutions contact
01242 663050
www.moduleco.com



For semi-permanent and lease hire options contact
01242 663060
www.healthcarehire.com

Our range covers all essential healthcare areas and includes:

- Operating theatres
 - General anaesthetic
 - Orthopaedic
 - Ophthalmic
- Recovery areas
- Wards
- Endoscopy suites
- Theatre sterile supply units
- Diagnostic rooms
- Patient and staff ancillary areas
- Isolation wards
- High dependency units
- Containment areas
- Pathology laboratories
- Mortuaries

State of the art theatre expansion

In just 24 weeks, two orthopaedic theatres were installed at Royal Berkshire Hospital, enabling the Trust to carry out an additional 2,800 operations a year



Twin Theatre, Recovery and Ward

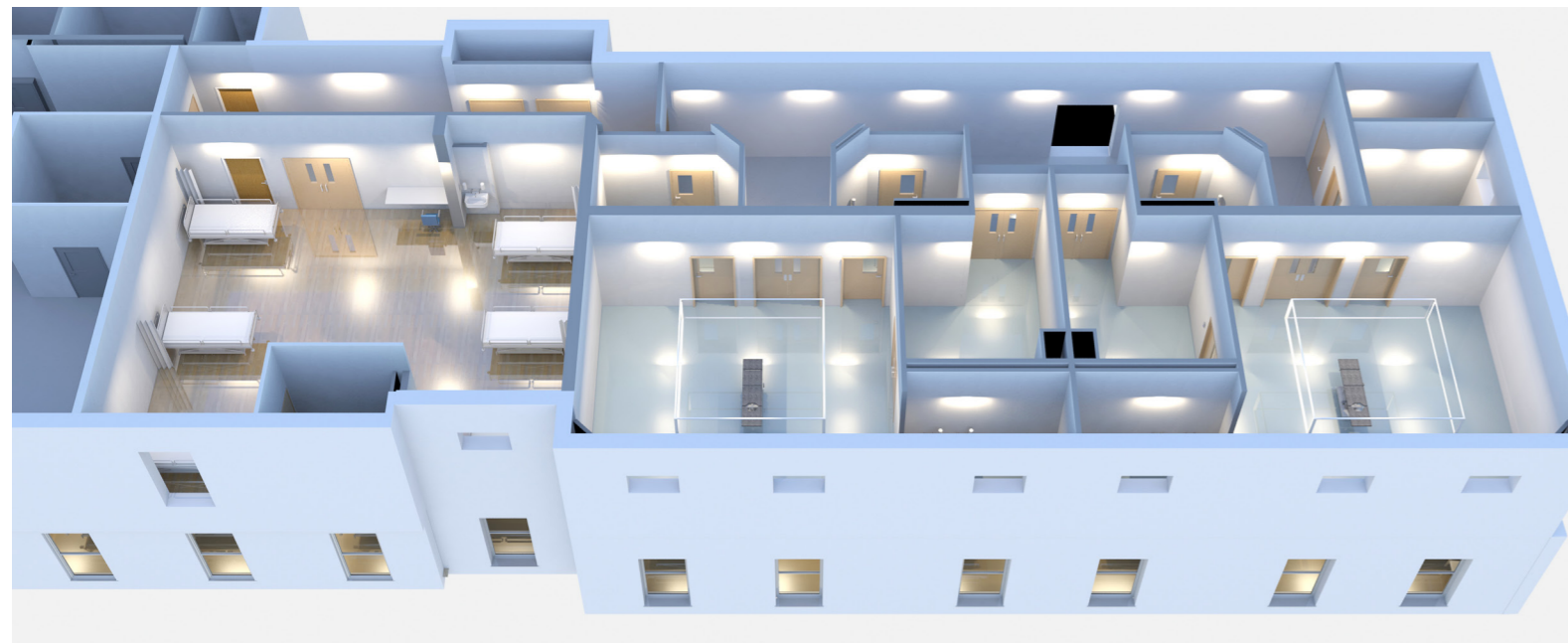

Do you need help with your next healthcare facility? Contact us, to discuss your requirements

For permanent solutions contact

01242 663050

For semi-permanent and lease hire options contact

01242 663060

Unique Delivery Methodology

Using our innovative pre-engineered sections, ModuleCo was able to offer a facility which incorporated a ground bearing slab floor, providing an increased structural stability. This unique approach enabled variable building heights, providing the trust with theatres with a 3m FFL ceiling height.



Key specifications:

- 2 full operating theatre suite with a scrub, 49m² operating room, anaesthetic, lay up prep and utility rooms
- 3m internal FFL to ceiling height in the operating room
- Electrical plant room and rooftop plantdeck for AHU
- All Group 1 equipment provided including operating theatre lamp, surgeon's panel and two medical gas pendants in the operating theatre
- Ground floor 10 bed ward
- Second floor 6 bed recovery
- 2No. laminar flow canopies
- Concrete floor throughout the facility
- 60-year structural design life



'Seamless finish both externally and internally'

ModuleCo also undertook refurbishment work to an existing ModuleCo theatre and ward, originally delivered in 2007. This additional work allowed ModuleCo to create a seamless finish between the two facilities both externally and internally. The use of curtain wall cladding created an aesthetically pleasing finish to the new theatres which was in keeping with the previous ModuleCo installation.



ORDER TO HANDOVER- 24 WEEKS